

General Specifications

Order-Code

DIWO-PS xx yy □ Y♦I△▲

Y Lead Terminal (length 300mm)

I 200mA 24V AC/DC Ratings

∅ Mounting

- 16mm
- 19mm
- 22mm

Operator

- 1P flat operator, height 1.0mm
- 3P flat operator, height 3.0mm
- 3Z with finger location, height 3.0mm
- 5P flat operator, height 4.5mm
- 5Z with finger location, height 4.5mm

□ Electrical function

- 10 NO
- 01 NC
- 10Z Latching ON-OFF

♦ Colours / Materials

- NT Natural anodized
- BU Blue anodized
- BK Black anodized
- GD Gold anodized
- GN Green anodized
- RD Red anodized
- SS Stainless Steel

△ LED Colour

- R Red
- G Green
- Y Yellow
- O Orange
- B Blue
- W White

▲ Lamp Voltage

- 05 Standard ring - 5VDC
- 12 Standard ring - 12VDC
- 24 Standard ring - 24VDC
- 05T thin ring - 5VDC
- 12T thin ring - 12VDC
- 24T thin ring - 24VDC
- 05L large ring - 5VDC
- 12L large ring - 12VDC
- 24L large ring - 24VDC

Sealing: IP68 / IK10
Vibration resistance: 10-500 Hz / 10 g
Operating temperature: -40°C to +75°C

Max. current/voltage rating: 1A 24VAC/DC
 200mA 24VAC/DC
 depending on version

Switch resistance ON: 10 Ωmax.
Switch resistance OFF: 5MΩ min.
Operating force: 2 to 6N

Life expectancy : 50 million cycles

LED consumption:
 Illuminated dot: 10mA
 Illuminated ring: 20mA

PC terminals: bronze, tin plated

Multi-wire leads section 0,22 mm
 length 300 mm, twisted by pair



Operating status description

Finger pressure applied to switch

1 = pressure
0 = no pressure

OUTPUT

10
Momentary NO (pulse)
No external power supply required

01
Momentary NC (pulse)
No external power supply required

10Z
Latching (ON-OFF)
Requires external power supply

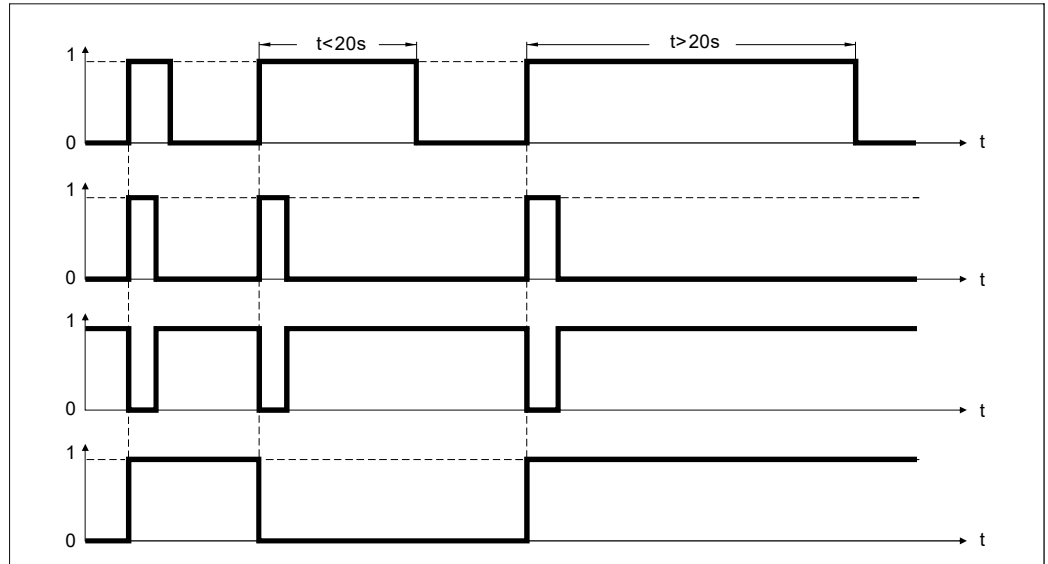

Wiring diagram

	Non-illuminated	1 LED*	2 LEDs	3 LEDs
Momentary NO (pulse)				
Momentary NO (pulse)				
Latching (ON-OFF)				

NOTE: X means the color of the wire depends on the color of the LED.

16mm



DIWO-PS16 5P □Y ◆1
Non-illuminated
operator height 4.50mm
flat

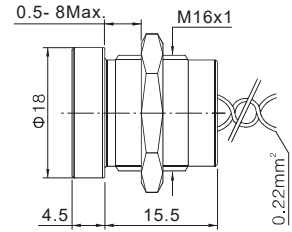

DIWO-PS16 5Z □Y ◆1
Non-illuminated
operator height 4.50mm
with finder location

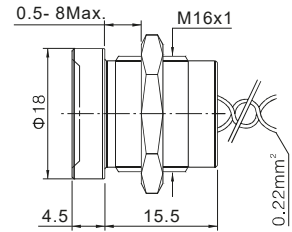

DIWO-PS16 1P □Y ◆1
Non-illuminated
operator height 1.00mm
flat

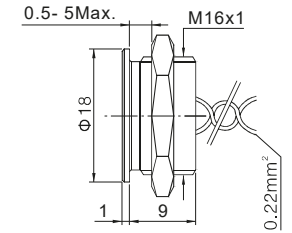

DIWO-PS16 5P □Y ◆1 ▲
Ring illuminated
operator height 4.50mm
flat

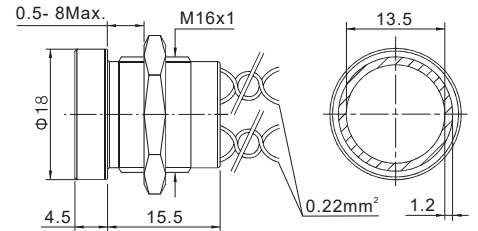

19mm



DIWO-PS19 3P □Y ◆1
Non-illuminated
operator height 3.00mm
flat

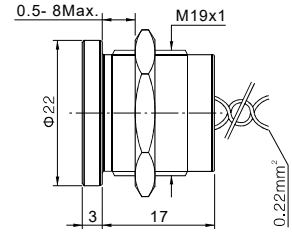

DIWO-PS19 3Z □Y ◆1
Non-illuminated
operator height 3.00mm
with finder location

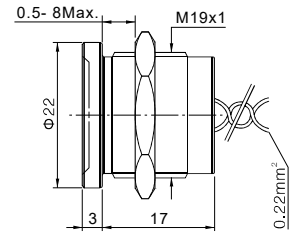



DIWO-PS19 3P □Y ◆1 △ ▲
Ring illuminated (thin ring)
operator height 3.00mm
flat

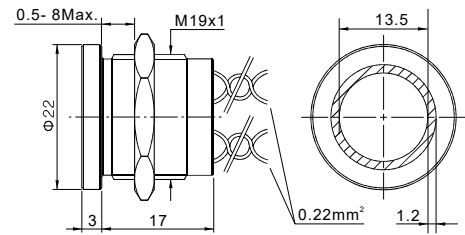

DIWO-PS19 3P □Y ◆1 △ ▲
Ring illuminated (large ring)
operator height 3.00mm
flat

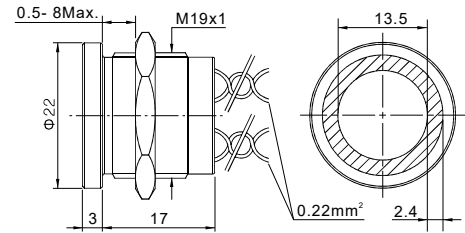

22mm



DIWO-PS22 3P □Y ◆1
Non-illuminated
operator height 3.00mm
flat

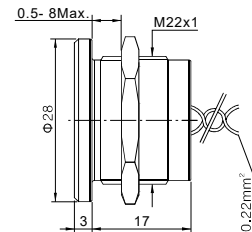

DIWO-PS22 3Z □Y ◆1
Non-illuminated
operator height 3.00mm
with finder location

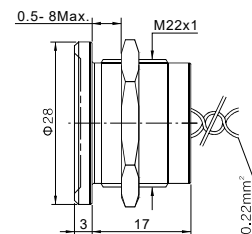

DIWO-PS22 3P □Y ◆1 △ ▲
Ring illuminated (thin ring)
operator height 3.00mm
flat

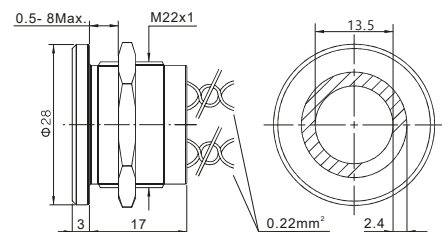

DIWO-PS22 5P □Y ◆1 △ ▲
Ring illuminated (large ring)
operator height 4.50mm
flat

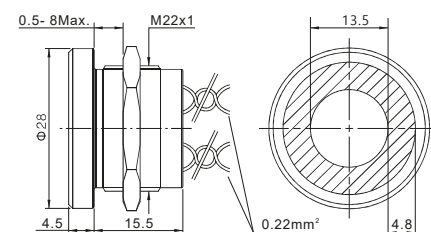



DIWO-PS22 3P □Y ◆1 ▲ D
with illuminated dot
operator height 3.00mm
flat

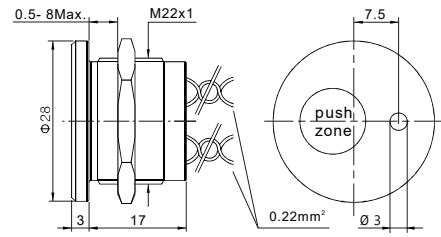

DIWO-PS22 3Z □Y ◆1 ▲ D
with illuminated dot
operator height 3.00mm
finger location

